

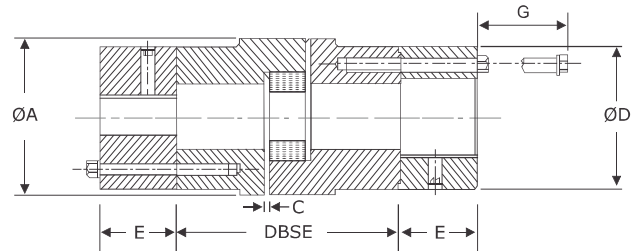

Riddhi Engineering Company

UTL USS COUPLINGS
(Spider Elastomer with Spacer)

UTL FLEXIBLE COUPLINGS



FEATURES

- Simple construction, quick and easy installation
- Spider design presets correct distance between hubs, using raised dimple on leg of the Spider
- Without disturbing the pump alignment & piping etc, maintenance is possible. Can also be used where quick disconnection of drive and driven units is required like compressors, generator & blowers etc.
- Range up to 265 Nm
- Maximum permissible misalignment: angular 1°, parallel 0.4 mm & axial 3 mm (initial alignment must be 25 % of maximum)

DIMENSIONS & TECHNICAL DATA

| Size | Rated Torque Nm | kW Rating at | | | Dimensions are in mm | | | | | | | | Torsional Stiffness Nm / rad | Wt in. Kg approx. | Moment of inertial (kg.m ²) |
|------|-----------------|--------------|----------|----------|----------------------|-----------|-------------------|-----|-----|----|---|----|------------------------------|-------------------|---|
| | | 100 rpm | 1500 rpm | 3000 rpm | Min. Bore | Max. Bore | DBSE | ØA | ØD | E | C | G | | | |
| 095 | 21.10 | 0.220 | 3.30 | 6.60 | 10 | 30 | 90, 100, 140 | 54 | 54 | 25 | 2 | 20 | 275 | 2.31 | On request UTL will provide data. According to spacer length. |
| 100 | 46.40 | 0.490 | 7.35 | 14.70 | 10 | 38 | 90, 100, 140 | 65 | 65 | 30 | 2 | 20 | 688 | 4.38 | |
| 110 | 89 | 0.930 | 13.95 | 27.90 | 15 | 42 | 90, 100, 140, 180 | 85 | 76 | 35 | 3 | 21 | 1719 | 5.62 | |
| 150 | 141 | 1.490 | 22.35 | 44.70 | 15 | 48 | 90, 100, 140, 180 | 96 | 90 | 40 | 3 | 27 | 2120 | 7.95 | |
| 190 | 190 | 2.010 | 30.15 | 60.30 | 20 | 55 | 90, 100, 140, 180 | 115 | 102 | 46 | 3 | 27 | 3495 | 11.57 | |
| 225 | 265 | 2.760 | 41.40 | 82.80 | 20 | 65 | 90, 100, 140, 180 | 127 | 115 | 52 | 3 | 21 | 4584 | 13.72 | |

• For non standard DBSE please contact UTL

MATERIAL SPECIFICATIONS

| | | | | |
|--------------------|----------------|------------------|-----|-------------------|
| Jaw | Size - 095-225 | Cast Iron | CI | DIN 1693 GG 20 |
| Adaptor | Size - 095-225 | Cast Iron | CI | DIN 1693 GG 20 |
| Spider 80° Shore A | All Size | Synthetic Rubber | NBR | ASTM D2000 BG 810 |
| Hex Bolt | All Size | High Tensile | St | ISO 4014 : Gr 8.8 |

• Alternative Spider for higher power ratings is available on request.

| | | | | | |
|------------------------------------|----------|------------------|------|-------------------|------------------------------|
| Spider 92° Shore A | All Size | Synthetic Rubber | NBR | ASTM D2000 BG 910 | Torque 1.6 times of standard |
| Spider 80° Shore A | All Size | Synthetic Rubber | EPDM | ASTM D2000 AA 810 | Torque as per standard |
| Spider 92° Shore A (Yellow Colour) | All Size | Polyurethane | PU | | Torque 1.8 times of standard |
| Spider 98° Shore A (Red Colour) | All Size | Polyurethane | PU | | Torque 2.5 times of standard |

• Max speed not to exceed surface speed V = 35m / sec

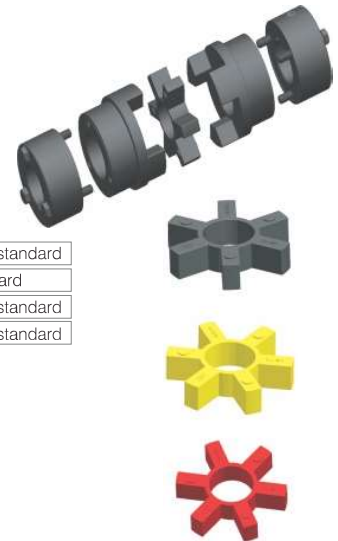

• For temperature range of elastomers please see on page no. 37 - coupling selection



Riddhi Engineering Company

www.couplings-mounts.com
sales@riddhiengineeringco.com
+91 74900 32784